

QUICK REFERENCE GUIDE

- ABOUT THE APP

www.royalsovereign.com

For iOS Devices

Note: when initially plugged in the default message will read **Display Message Sign.**

Messages

Create customized messages with display message sign.

1. Press the **+** button at the top to create a new message.
2. Type in your message. For example "Daily Special."

Use optional settings to set color, delay, entry and speed :

Settings include:

Color Letters - Used to customize each letter (Red, Orange, Green).

Color - Used to set all characters and words to a specific setting (alternate, red, orange, green).

Speed - Used to control entry speed (Fast or Slow).

Delay - Used to control the duration of the message on screen.

Entry - Used to control direction message will be displayed (Right to Left, Up, Down, Flashing options).

To delete messages:

Slide the message to left to delete.

Playlists

Create customized playlists to display at different times throughout the day or week.

1. Press the **PLAYLIST** button located at the bottom of the APP.
2. Press the **+** button at the top to create a new playlist.
3. Enter a playlist title. Then ok. Press to select the newly created playlist title to open and edit.
4. Click "list" to access your previously created messages.
5. Select the messages you wish to include. The order in which you select the messages is the order they will be displayed.
6. When finished selecting order, press done.
7. Press "play" to begin displaying the playlist.

To delete a playlist:

Slide the playlist to left to delete.

Settings

Use the Settings function to turn ON/OFF the Display Message Sign or to create a new password used to enter the APP (default password setting is '000').

POWER ON /OFF

Toggle the power button to turn the sign ON/OFF

PASSWORD



Messages 1

Messages 2-1

Messages 2-2

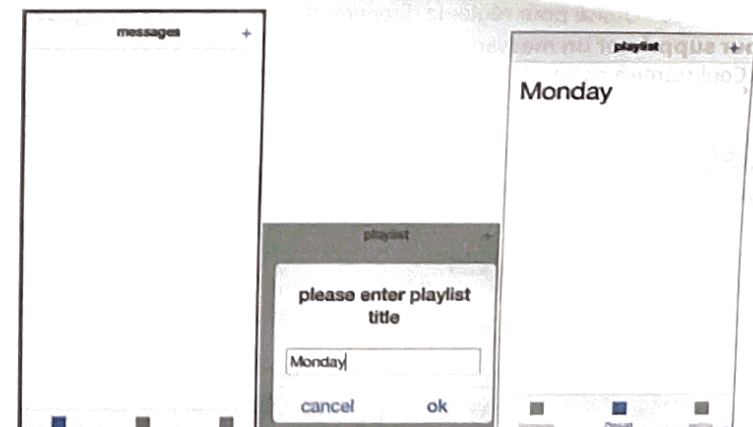

Playlists 1

Playlists 2

Playlists 3

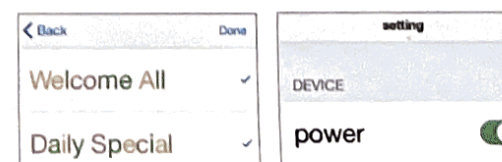

For Android Devices

Note: when initially plugged in the default message will read
Display Message Sign.

Messages

Create customized messages with display message sign.

1. Press the button at the top to create a new message.
2. Type in your message. For example "Free Coffee."

Use optional settings to set color, delay, entry and speed :

Settings include:

Color Letters - Used to customize each letter (Red, Orange, Green).

Color - Used to set all characters and words to a specific setting (alternate, red, orange, green).

Speed - Used to control entry speed (Fast or Slow).

Delay - Used to control the duration of the message on screen .

Entry - Used to control direction message will be displayed (Right to Left, Up, Down, Flashing options).

To delete messages:

1. Select the message you wish to delete by pressing the box to the right of the message. The box will now be checked.
2. With the messages checked press the button at the top.

Playlists

Create customized playlists to display at different times throughout the day or week.

1. Press the PLAYLIST button located at the bottom of the APP.
2. Press the button at the top to create a new playlist.
3. Enter a playlist title. Then ok. Press to select the newly created playlist title to open and edit.
4. Press the button at the top to access your previously created messages.
5. Select the messages you wish to include by pressing the box to the right of the message. The order in which you select the messages is the order they will be displayed.
6. When finished selecting order, press done.
7. At the top left press play to begin displaying the playlist.

To delete a playlist:

1. Select the playlist you wish to delete by pressing the box to the right of the playlist. The box will now be checked.
2. With the playlist checked press the button at the top.

Settings

Use the Settings function to turn ON/OFF the Display Message Sign or to create a new password used to enter the APP (default password setting is '000').

POWER ON /OFF

Toggle the power button to turn the sign ON/OFF

PASSWORD

To change the APP default password of '000', select the reset password option. Enter any 3 digit numeric number and press to confirm.

If you forget the password, press the green button for 5 seconds ..seconds located at the ..at the right side of the product. The password will return to the default "000" setting.



Playlists 4



POWER ON /OFF

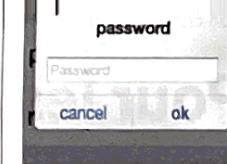

PASSWORD



Messages 1

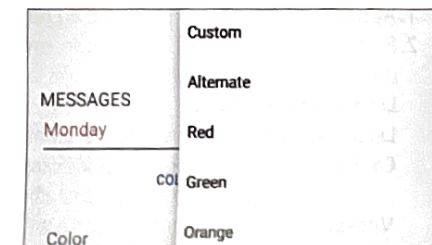

Messages 2



Playlists 1

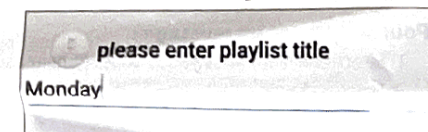

Playlists 2



Playlists 3

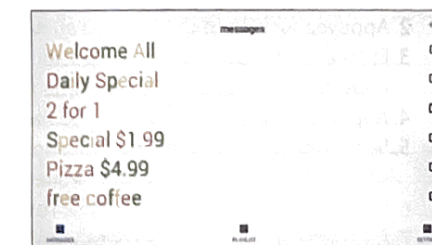

Playlists 4



PASSWORD

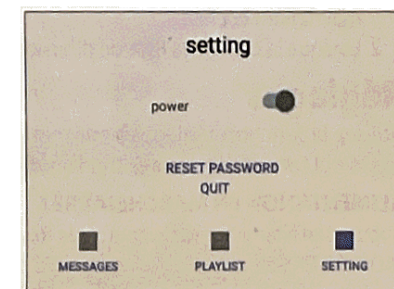

POWER ON /OFF