

RYOBI



REGISTER YOUR TOOLS

<http://register.ryobitools.com>

1-800-525-2579

OPERATOR'S MANUAL

MANUEL D'UTILISATION

MANUAL DEL OPERADOR

18 VOLT BUCKET TOP

22 ft. MISTING SYSTEM

SYSTÈME DE BRUMISATION 18 V

DE 6,7 mm (22 pieds)

AVEC TÊTE EN SEAU

SISTEMA DE ROCIADO

PARA BOCA DE

CUBETA DE 18 V

y 6,7 mm (22 pies)

PMP01

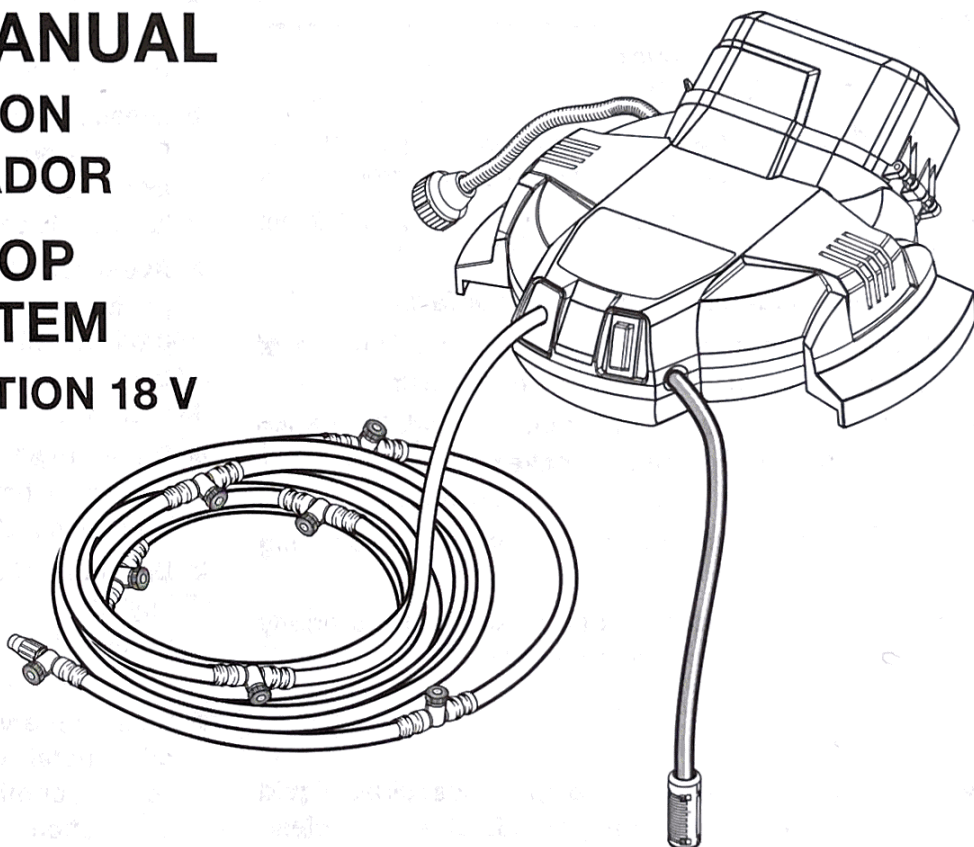

TABLE OF CONTENTS

■ Important Safety Instructions	2-3
■ Symbols	4
■ Assembly	5
■ Operation	5-7
■ Maintenance	7
■ Accessories	8
■ Troubleshooting	8
■ Illustrations	ii-v
■ Parts Ordering/Service	Back page



WARNING: To reduce the risk of injury, the user must read and understand the operator's manual before using this product.

TABLE DES MATIÈRES

■ Instructions importantes concernant la sécurité	2-3
■ Symboles	4
■ Assemblage	5
■ Utilisation	5-7
■ Entretien	7
■ Accessoires	8
■ Dépannage	8
■ Illustrations	ii-v
■ Commande de pièces/dépannage	Page arrière



AVERTISSEMENT : Pour réduire les risques de blessures, l'utilisateur doit lire et veiller à bien comprendre le manuel d'utilisation avant d'employer ce produit.

ÍNDICE DE CONTENIDO

■ Instrucciones de seguridad importantes	2-3
■ Símbolos	4
■ Armado	5
■ Funcionamiento	5-7
■ Mantenimiento	7
■ Accesorios	8
■ Corrección de problemas	8
■ Ilustraciones	ii-v
■ Pedidos de repuestos/servicio	Pág. posterior



ADVERTENCIA: Para reducir el riesgo de lesiones, el usuario debe leer y comprender el manual del operador antes de usar este producto.

**SAVE THIS MANUAL FOR
FUTURE REFERENCE**

**CONSERVER CE MANUEL
POUR FUTURE RÉFÉRENCE**

**GUARDE ESTE MANUAL
PARA FUTURAS CONSULTAS**

IMPORTANT SAFETY INSTRUCTIONS



WARNING

READ AND UNDERSTAND ALL INSTRUCTIONS. Failure to follow all instructions listed below, may result in electric shock, fire and/or serious personal injury.

- **Children can fall into buckets and drown.** Keep children away from buckets with even a small amount of liquid.
- **To reduce the risk of injury,** close supervision is necessary when a product is used near children.
- **Do not allow children to operate this product.** It is not a toy.
- **Exercise caution to avoid slipping or falling.**
- **Use only recommended accessories.** The use of improper accessories may cause risk of injury.
- **Never leave product running unattended.** Turn hose faucet completely off and remove battery pack. Don't leave product until spray comes to a complete stop.
- **Never direct mist or water toward any electrical wiring or devices.**
- **Ensure that all hoses and accessories are properly connected before using the product.**
- **ONLY use clean, cold water.**
- **For outdoor use ONLY.**
- **Do not use this misting kit to spray pesticides, liquid fertilizers, chemicals, or any liquids other than clean water.** Spraying these substances could result in serious injury or illness to the operator or bystanders.
- **Make sure hose and mist tube are located so that they will not be stepped on, tripped over, come in contact with sharp edges or moving parts or otherwise subjected to damage or stress.** This will reduce the risk of accidental falls, which could cause injury, and damage to the hose and mist tube which could prevent the product from working properly.
- **Use caution when positioning the product for use.** Never place the unit near electrical outlets or switches.
- **Check hoses and parts for signs of damage.** Replace any damaged hoses or parts.
- **Verify that all connections are secure before operating the unit.**
- **Use caution when using in windy conditions.** Winds may carry mists into electrical wiring or devices.
- **Do not kink or overbend the hose or mist tube.**
- **Be careful not to spill water when filling water bucket.** Ensure all hose connections are secure before using misting kit. Spilled water and leaks can result in a slippery surface and create a slip and fall hazard.

BATTERY PRODUCT USE AND CARE

- **Use battery operated products only with specifically designated battery pack.** Use of any other batteries may create a risk of fire.
- **Use battery only with charger listed.** For use with 18V lithium-ion battery packs, see tool/appliance/battery pack/charger correlation supplement 987000-432.
- **Dress properly. Do not wear loose clothing or jewelry. Contain long hair. Keep your hair, clothing, and gloves away from moving parts.** Loose clothes, jewelry, or long hair can be caught in moving parts.
- **Avoid accidental starting. Be sure switch is in the off position before inserting battery pack.** Carrying battery products with your finger on the switch or inserting the battery pack into a product with the switch on invites accidents.
- **Do not use battery product if switch does not turn it on or off.** A battery product that cannot be controlled with the switch is dangerous and must be repaired.
- **Disconnect battery pack from product before making any adjustments, changing accessories, or storing the product.** Such preventive safety measures reduce the risk of starting the product accidentally.
- **When battery pack is not in use, keep it away from other metal objects like: paper clips, coins, keys, nails, screws, or other small metal objects that can make a connection from one terminal to another.** Shorting the battery terminals together may cause sparks, burns, or a fire.
- **Keep the product dry, clean and free from oil and grease.** Always use a clean cloth when cleaning. Never use brake fluids, gasoline, petroleum-based products, or any strong solvents to clean your battery product. Following this rule will reduce the risk of loss of control and deterioration of the enclosure plastic.
- **Know your product. Read operator's manual carefully.** Learn its applications and limitations, as well as the specific potential hazards related to this battery product. Following this rule will reduce the risk of electric shock, fire, or serious injury.
- **Battery products do not have to be plugged into an electrical outlet; therefore, they are always in operating condition. Be aware of possible hazards when not using your battery product or when changing accessories.** Following this rule will reduce the risk of electric shock, fire, or serious personal injury.
- **Do not place battery products or their batteries near fire or heat.** This will reduce the risk of explosion and possibly injury.

ASSEMBLY

WARNING:

Do not use this product if it is not completely assembled or if any parts appear to be missing or damaged. Use of a product that is not properly and completely assembled or with damaged or missing parts could result in serious personal injury.

WARNING:

Do not attempt to modify this product or create accessories or attachments not recommended for use with this product. Any such alteration or modification is misuse and could result in a hazardous condition leading to possible serious personal injury.

If any parts are damaged or missing, please call 1-800-525-2579 for assistance.

OPERATION

WARNING:

Do not allow familiarity with products to make you careless. Remember that a careless fraction of a second is sufficient to inflict serious injury.

WARNING:

Keep water and mist discharge pointed away from all electrical devices to reduce the risk of electrocution or electric shock.

WARNING:

Ensure all hose connections are secure before using misting kit. Spilled water and leaks can result in a slippery surface and create a slip and fall hazard.

WARNING:

Do not use any attachments or accessories not recommended by the manufacturer of this product. The use of attachments or accessories not recommended can result in serious personal injury.

WARNING:

Always remove battery pack from the product when you are assembling parts, making adjustments, cleaning, or when not in use. Removing battery pack will prevent accidental starting that could cause serious personal injury.

WARNING:

Do not use this product to spray pesticides, liquid fertilizers, chemicals, or any liquids other than clean water. Spraying these substances could result in serious injury or illness to the operator or bystanders.

APPLICATIONS

You may use this product for the following purposes:

- Outdoor cooling while connected to a 5-gallon bucket or garden hose

FLUSH THE SYSTEM AND TEST FOR LEAKS

To ensure the product functions properly, always flush and test the system for leaks before use.

To flush the system:

- Remove end cap and nozzles.
- With the hose faucet turned completely off, attach a garden hose (not provided) to the garden hose connector and hand tighten.
- Turn faucet on and allow water to run through the garden hose and misting tube for 30 seconds to wash away any debris. Then turn faucet off.

To test the system:

- Replace end cap and nozzles.
- Turn faucet on fully and allow water to run through the garden hose and misting tube to pressurize the unit.
NOTE: Make sure the faucet is turned on fully and that there are no kinks or leaks in the hose.
- Check each threaded hole on the misting tube for leaks. If leaks are present, refer to the Troubleshooting section later in the manual.

PUMP ON/OFF SWITCH

See Figure 1, page 9.

The pump switch is located on the right front of the base.

- To turn the pump **ON**, press (I).
- To turn the pump **OFF**, press (O).

INSTALLING/REMOVING THE BATTERY PACK

See Figure 2, page 10.

NOTE: This product is not recommended for use with RYOBI ONE+ battery packs larger than 4.0Ah. If installed, large capacity battery packs will prevent the battery cover from

closing completely exposing the battery and the battery port to moisture, debris, and other contaminants.

- Set pump switch to the **OFF (O)** position.
- Press the tab to open the battery compartment latch.
- Insert the battery pack into the battery port.
- Make sure the latches on each side of the battery pack snap into place and the battery pack is secured before beginning operation.
- Close the battery compartment cover and press until it snaps shut.

MOUNTING THE MISTING KIT

See Figures 3 - 5, page 10.

WARNING:

Install alligator clamps in an area where no electrical wires, utility cables, pipes, or other obstructions are located. Never connect alligator clips to electrical wires or cords. Contact your local utility company or a qualified electrician if you are unsure. Ensure alligator clamps and misting tube are securely installed to prevent falling object or slippery surface hazard. Failure to follow these instructions can result in electrical shock or other serious personal injury.

NOTICE:

This misting kit is designed to be attached to fabric surfaces, such as umbrellas or fabric awnings, using the included alligator clips. To attach the misting kit to other surfaces, an accessory hanging mount kit must be used.

To obtain the best spray area (mist curtain), we recommend the misting tube be secured to an overhead support. Always mount the misting kit in a suitable location away from electrical devices and switches.

To mount the misting kit:

- Set pump switch to the **OFF (O)** position and remove the battery pack.
- Use the plastic straps on the alligator clamps to secure the misting tube to the clamps.
- Squeeze the ends of the clamp to open the clamp mouth and install the misting kit in a suitable location.

USING THE MISTING KIT WITH A WATER BUCKET (NOT INCLUDED)

See Figures 6 - 8, pages 10 and 11.

WARNING:

Children can fall into buckets and drown. Keep children away from buckets with even a small amount of liquid.

The misting kit is designed to operate on top of a 5-gallon water bucket.

NOTE: Clean the bucket with soap and water before each use.

- Place the bucket on a flat, level surface.
- Set the pump switch to the **OFF (O)** position.
- Set the pump's base securely onto the rim of the bucket, allowing end of the intake tube to go straight down into the bucket.

NOTE: The pump cannot be secured to the bucket; they cannot be moved as a single unit.

- Install the battery pack and close the battery compartment cover.
- Add **ONLY** clean, cold water into the bucket. Do not overfill.
- With the misting kit mounted in your desired location, away from electrical devices and switches, start the pump, and allow the system to pressurize.

WARNING:

When filling, moving, or emptying bucket, be careful not to spill water and do not overfill bucket. Spilled water can result in a slippery surface, create a slip and fall hazard, and cause property damage.

- After adequate pressure is reached, water should mist from the nozzles to the surface below. If misting does not occur within 10 seconds, shut off the pump, and refer to the *Troubleshooting* later in this manual.

To move the misting kit to another location:

- Set the pump switch to the **OFF (O)** position.
- Allow the the pump to stop running, then lift the pump off the bucket and move as desired.

NOTE: The intake tube cannot be removed, but may be stored in the space provided on the unit.

USING THE MISTING KIT WITH A GARDEN HOSE (NOT INCLUDED)

See Figure 9, page 11.

WARNING:

Always route hoses away from traffic areas to prevent a tripping hazard.

NOTE: The pump is not needed when the misting kit is connected to a garden hose. Using the pump unnecessarily may cause additional wear and shorten the life of the unit.

- Set the pump base on a flat, steady surface, such as a concrete patio or tabletop.

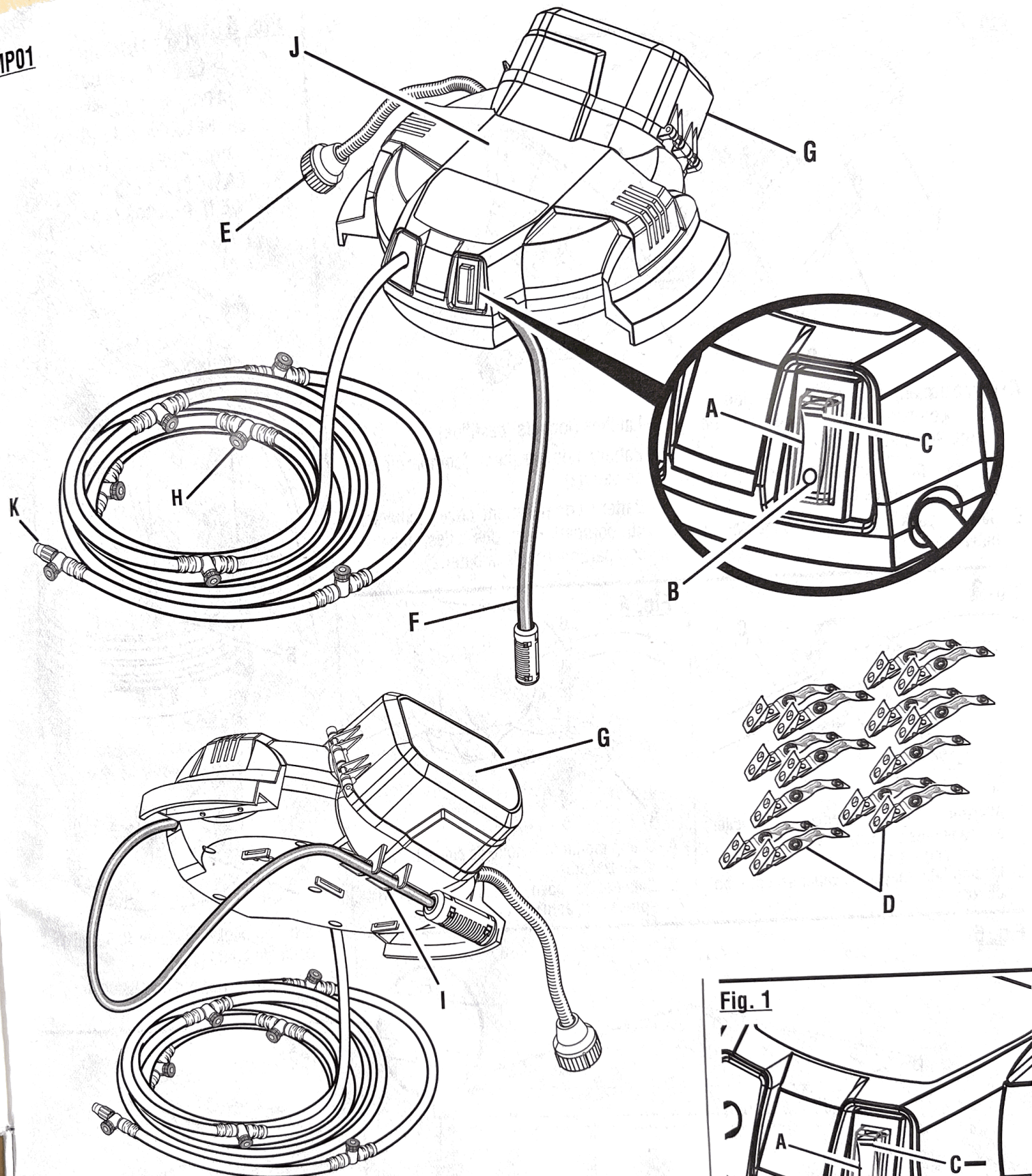

- A - Pump on/off switch (interrupteur marche/arrêt de pompe, interruptor de encendido/apagado de bomba)
- B - OFF (○) [arrêt (○), apagado (○)]
- C - ON (I) [marche (I), encendido (I)]
- D - Alligator clamp (pince crocodile, abrazadera de caimán)
- E - Garden hose connector (raccord du boyau d'arrosage, conector de la manguera de jardín)
- F - Intake tube (tube d'admission, tubo de nebulización)

- G - Battery compartment (compartiment de piles, compartimiento de baterías)
- H - Misting nozzles (buses de vaporisation, boquilla para rociar)
- I - Intake tube storage (rangement du tube d'admission, almacenamiento del tubo de nebulización)
- J - Pump base (base de pompe, base de la bomba)
- K - End cap (le capuchon, la tapa del extremo)

Fig. 1

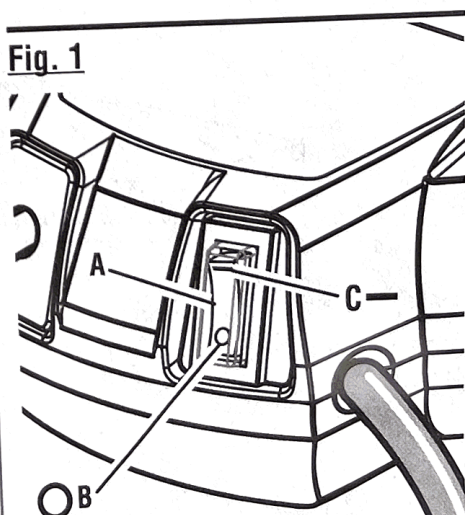

- A - Pump on/off switch (interrupteur marche/arrêt de pompe, interruptor de encendido/apagado de bomba)
- B - OFF (○) [arrêt (○), apagado (○)]
- C - ON (I) [marche (I), encendido (I)]

Fig. 2

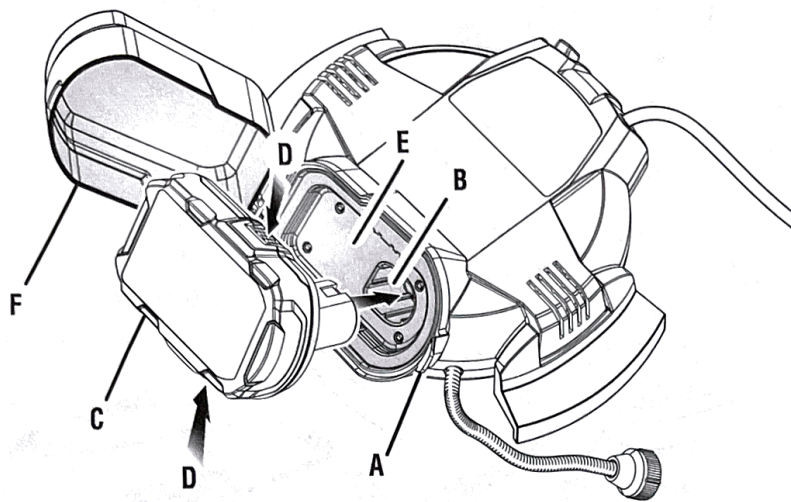

- A - Compartment latch (loquet de compartiment, pestillo de compartimiento)
- B - Battery port (logement de piles, receptáculo de las baterías)
- C - Battery pack (bloc-piles, paquete de baterías)

- D - Latches (loquets, pestillos)
- E - Battery compartment (compartimiento de batería)
- F - Battery compartment cover (couvercle du compartiment des piles, tapa del compartimiento de la batería)

Fig. 3

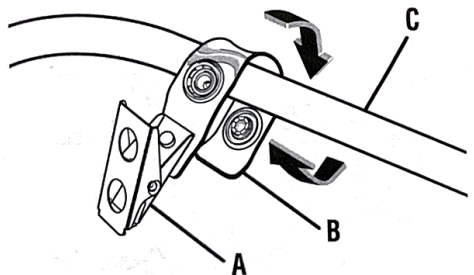

- A - Alligator Clamp (pince crocodile, abrazadera de caimán)
- B - Strap (sangle, correa)
- C - Misting tube (boyau de vaporisation, tubo de rociado)

Fig. 4

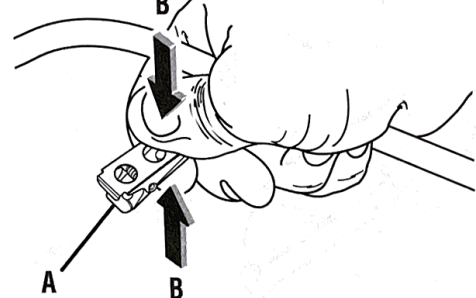

- A - Clamp mouth (mâchoire de pince, boca de la abrazadera)
- B - Squeeze to open (presser pour ouvrir, apriete para abrir)

Fig. 5

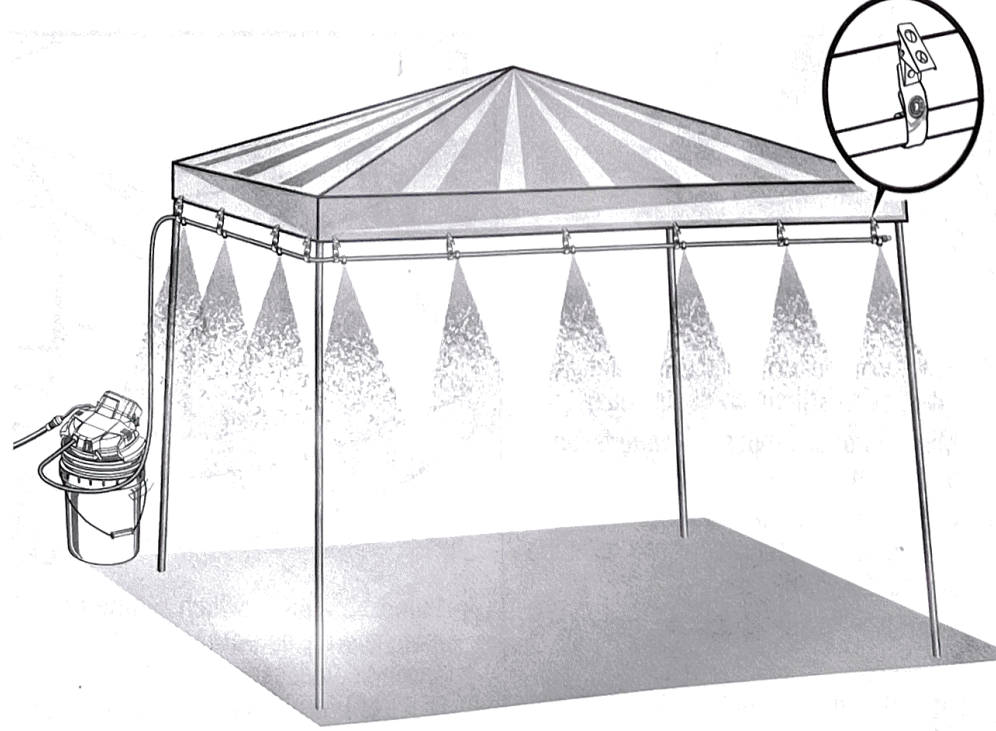
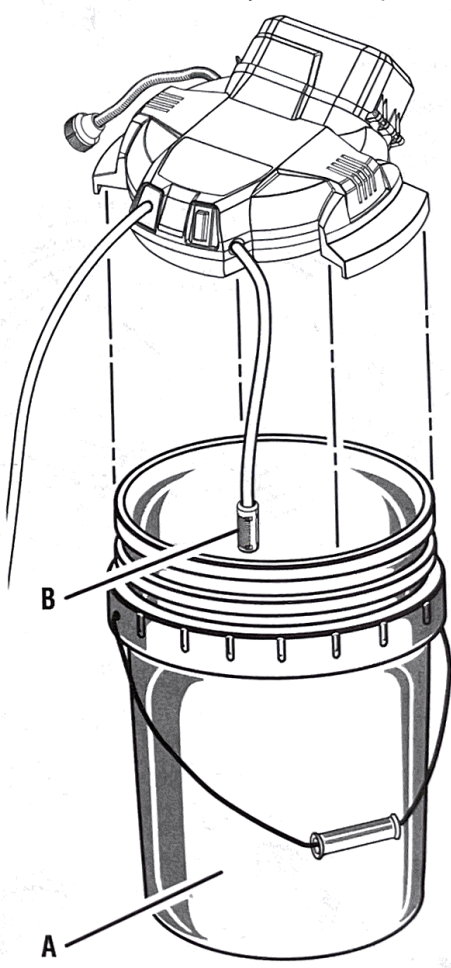

Fig. 6

PLACE PUMP ON TOP OF 5-GALLON BUCKET
DÉPOSER LE POMPE SUR UN SEAU DE 18,9 L (5 GAL)
COLOQUE LA BOMBA EN LA PARTE SUPERIOR DE UN CUBO DE 18,9 LITROS (5 GALONES)



- A - 5-gallon bucket [seau de 18,93 l (5 gal.), balde de 18,93 l (5 gal.)]
- B - Intake tube (tube d'admission, tubo de nebulización)

Fig. 7

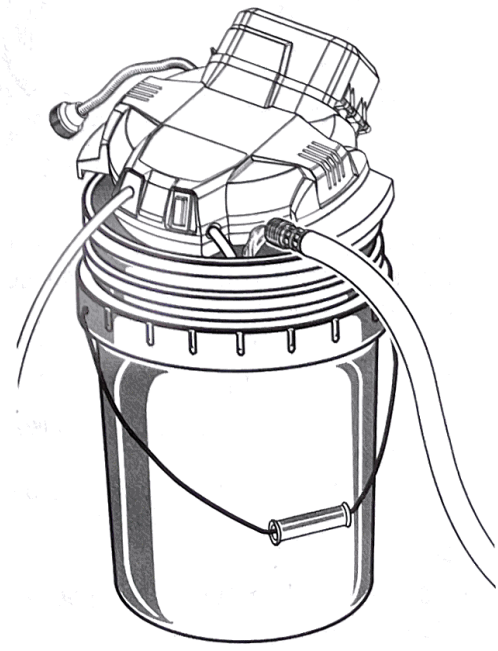
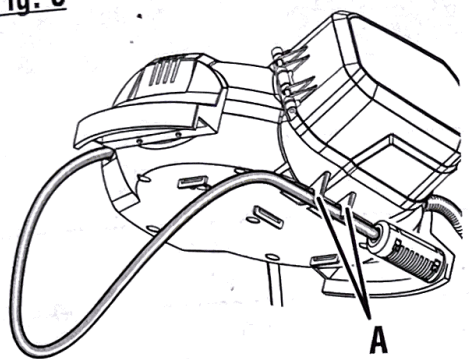
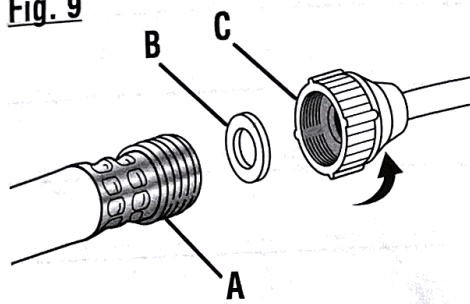

Fig. 8



A - Intake tube storage (rangement du tube de prise d'eau, almacenamiento para el tubo de entrada)

Fig. 9



A - Garden hose (tuyau d'arrosage, manguera de jardín)
B - O-Ring (joint torique, junta tórica)
C - Garden hose connector (raccord du boyau d'arrosage, conector de la manguera de jardín)

Fig. 10

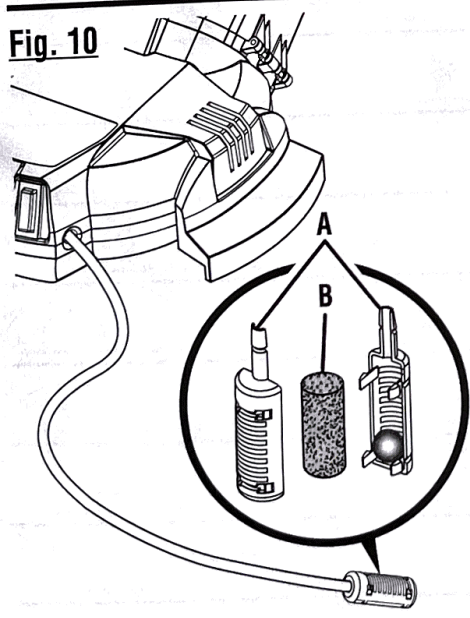

A - Filter cover (couvercle filtre, cubierta filtro)
B - Filter (filtre, filtro)